

ROOF CENTRIFUGAL EXTRACTOR FANS

SERIES ATS

- ➔ compact
- ➔ horizontal flux

DESCRIPTION:

The extractor fans of the ATS are designed for roof mounting and are suitable for foul air extraction from large industrial environments, like warehouses, workshops, parking areas, locker rooms etc., and anywhere is required high air volumes and pressures.

The design features of these centrifugal fans allow quick and secure installation on the tops of the vent ducts. Due to their compactness, they can be used for a wide range of applications in a discrete and pleasant manner.

MAIN FEATURES:

- External body in high density structure plastic material and particularly resistant against the atmospheric agents corrosion action.
- Motor with backward-curved radial impeller built in the stator.
- "LONG LIFE" ball bearings and thermal protection on single-phase models.
- Galvanized steel protection grille.
- For continuous operation in environments with max temperature 40°C.
- 2 speed models can be controlled by a three-phase switch ($\Delta \lambda$), not supplied as an accessory, but easy to find on sale.

ACCESSORIES:

- Phase slicing speed regulator for monophase motors.
- Protection grille (extraction side) supplied as an accessory.
- Counter-basement.
- Backdraught gravity shutter.

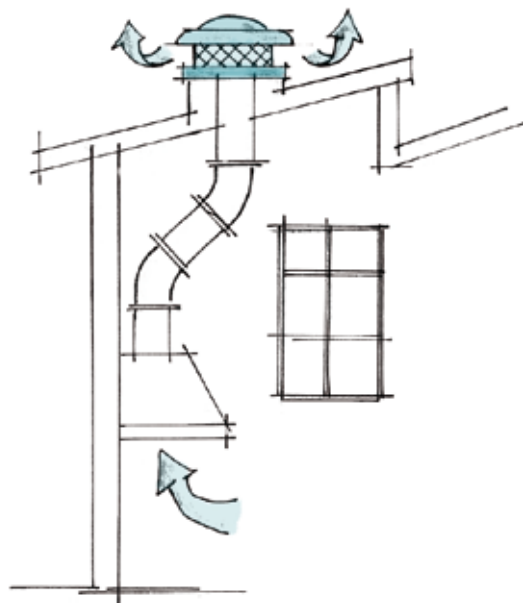

DIMENSIONS

MODEL	AxA	BxB	C	DxD	ØE	H
ATS 5	340	410	35	295	160	190
ATS 10	465	610	50	420	220	310
ATS 18	465	610	50	420	260	310
ATS 35	605	785	50	540	320	420
ATS 50	605	785	50	540	350	420

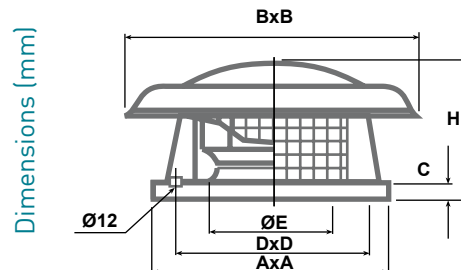

TECHNICAL SPECIFICATIONS

ATS SERIES - MONOPHASE

230/240V - 50HZ

CODE	MODEL	m³/hr	Pt max mmH ₂ O	Ref. curves	Rpm nom.	MOTOR				dB(A) 3 mt	Kg
						Kw	A	Cl. Is.	IP		
2 POLES											
AP7591	ATS 5 MF	500	33	1	2800	0,08	0,36	B	44	63	5,2
4 POLES											
AP7617	ATS 10 MF	1000	16,5	6	1400	0,09	0,4	B	44	58	12,4
AP7633	ATS 18 MF	1750	24	7	1400	0,15	0,65	B	44	65	13,6

ATS SERIES - 2 SPEED THREE-PHASE

400V - 50Hz

CODE	MODEL	m³/hr	Pt max mmH ₂ O	Ref. curves	Rpm nom.	MOTOR				dB(A) 3mt	Kg.	
						Kw	A	Cl. Is.	IP			
4 - 6 POLES												
AP7609	ATS 10 TF	1000/720	16/13	4	8	1400/950	0,065	0,25	B	41	58/51	12,2
AP7625	ATS 18 TF	1750/1300	24/20	5	9	1400/950	0,15	0,4	B	41	65/58	13,5
AP7641	ATS 35 TF	3500/2500	38/29	6	10	1400/950	0,37	0,85	F	54	76/73	26,1
AP7666	ATS 50 TF	4750/3400	44/34	7	11	1400/950	0,52	1,1	F	54	74/67	28,0

ACCESSORIES

COUNTER-BASEMENT

CODE	MODEL	for use with:	AxA	BxB	fixing MA
AP7757	CBT 10/18	ATS 10 and 18 series	440	415	8 MA
AP7765	CBT 35/50	ATS 35 and 50 series	590	535	8 MA

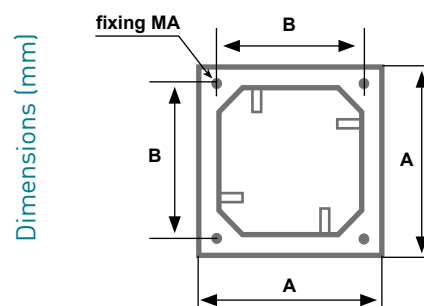

BACKDRAUGHT GRAVITY SHUTTER

CODE	MODEL	for use with:	ØA	ØB	C	ØD	E
AP2311	SGT 20	ATS 10 and 18 series	309	251	210	283	N°3xM8
AP2337	SGT 40	ATS 35 and 50 series	409	352	230	381	N°4xM8

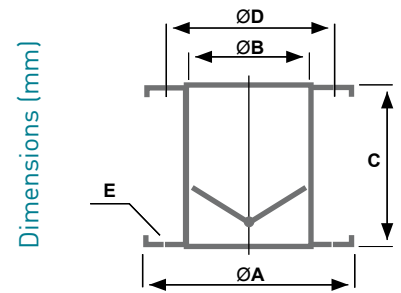

PROTECTION GRILLE

CODE	MODEL	for use with:
AP7187	GDP 200/5	ATS 5 MF series
AP7708	GDP 10/18	ATS 10 and 18 series
AP7716	GDP 35/50	ATS 35 and 50 series

MONOPHASE SPEED REGULATORS

CODE	to control the ATS series models	
AP2568	RDV 1,5-MF	5 MF, 10 MF, 18 MF



CHARACTERISTIC CURVES

ATS SERIES - 2 POLES - 2800 RPM

1 5 MF

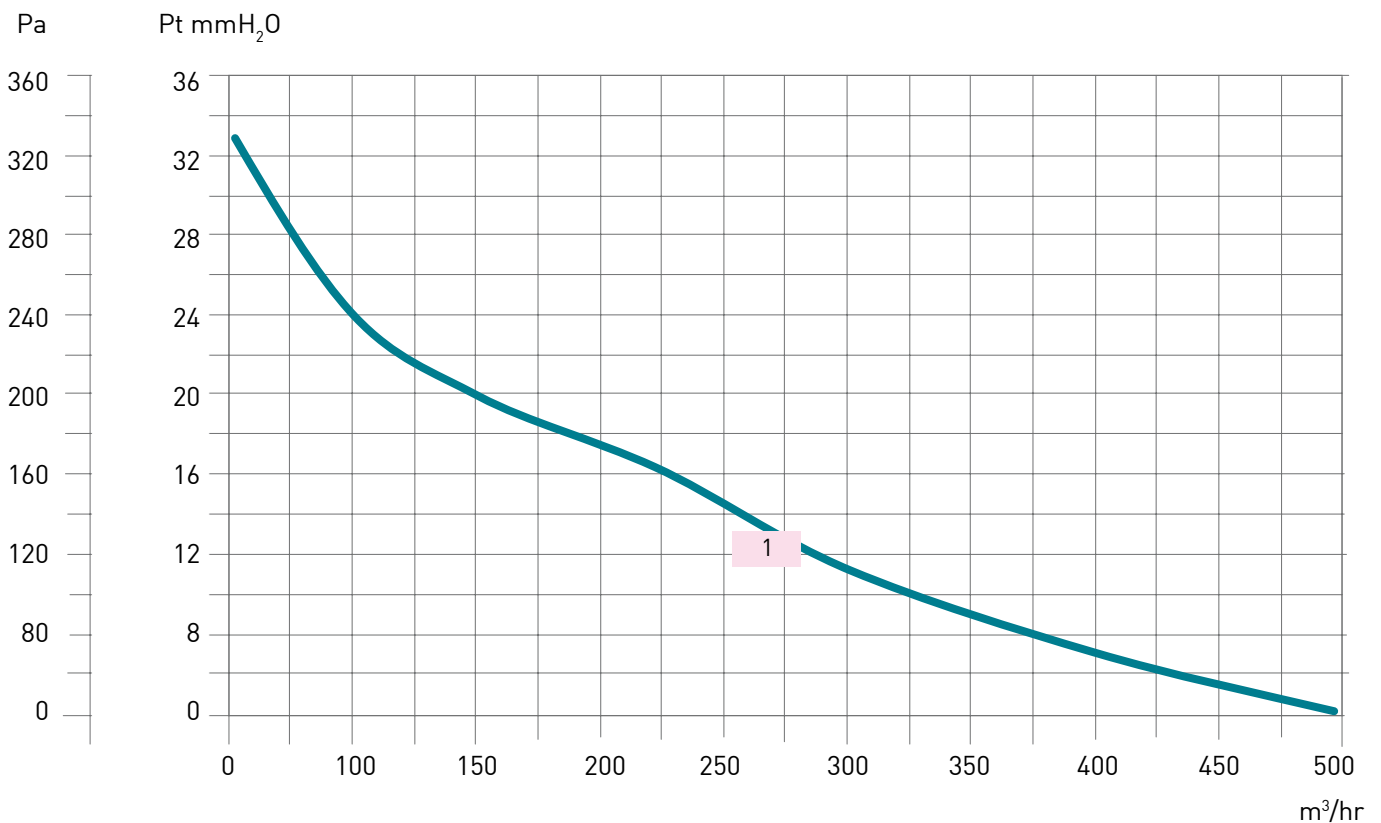

ATS SERIES - 4 POLES - 1400 RPM

2 10 MF

3 18 MF

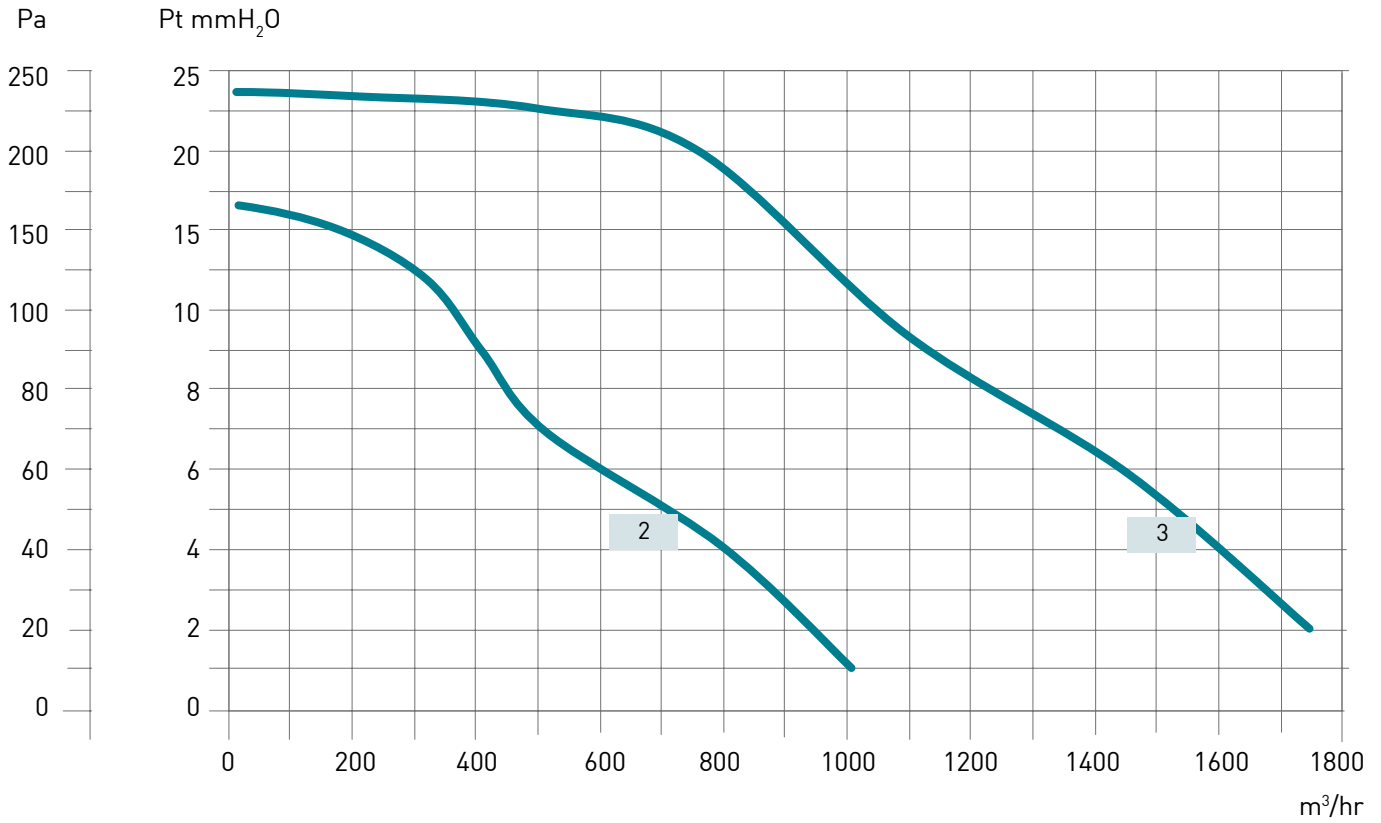

ATS SERIES - 4/6 POLES - 1400/950 RPM

4 10 TF (4 poles) high speed

6 35 TF (4 poles) high speed

8 10 TF (6 poles) low speed

10 35 TF (6 poles) low speed

5 18 TF (4 poles) high speed

7 50 TF (4 poles) high speed

9 18 TF (6 poles) low speed

11 50 TF (6 poles) low speed

